



SWP Australia Pty Ltd

Spirally Wound Pipes for Australia

Bridge Column Formwork



Owner:

Main Roads WA

Contractors:

CPB Contractors
Monford

Technical Description:

27 x Lined DN1500 Formwork
Columns, 6000mm long

Profile used: R3

Installation:

Muchea, Dec 2018
North link WA, Stage 3

SWP Australia Pty Ltd
16 Colin Jamieson Drive
Welshpool, WA 6106, Australia
p: 08 9358 3273
e: admin@swpaustralia.com.au
www.swpaustralia.com.au

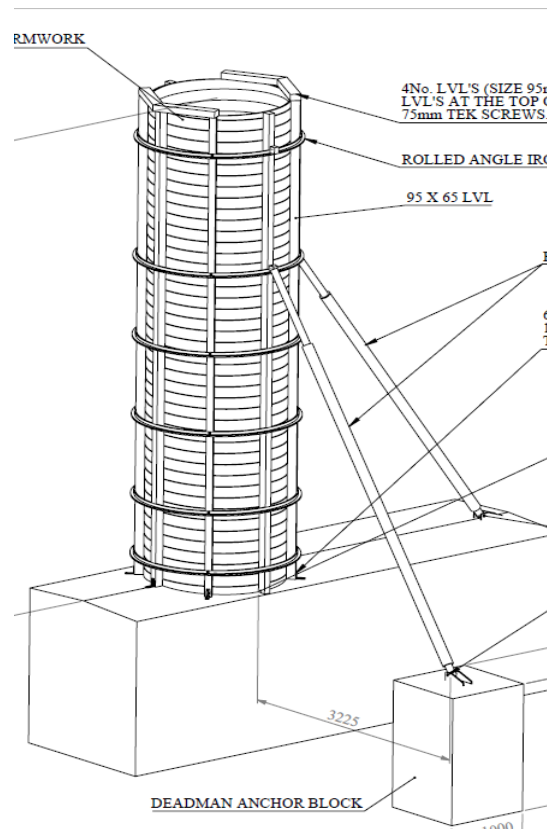

When Monford ordered 27 x columns, DN1500 and 6m long, we were not aware of all the technical details that still needed to be answered.

It did not just require quality columns but also engineering calculations incl. max rate of pour and detailed 3D bracing design suggestions.

The design had to include the determination of the LVL, angle iron rings, push-pull props, size and position of the Deadman anchor blocks, etc.

The bottom section of the columns needed a 50mm chamfer and there was concern about leaking. Sealing the gap and securing the LVL to the concrete base (see pic above), pouring the concrete in 2m section, proved a successful combination and the columns were poured without any issues at all.



SWP Australia Pty Ltd

Spirally Wound Pipes for Australia

